

# Another Exquisite Home by Timberland Estates

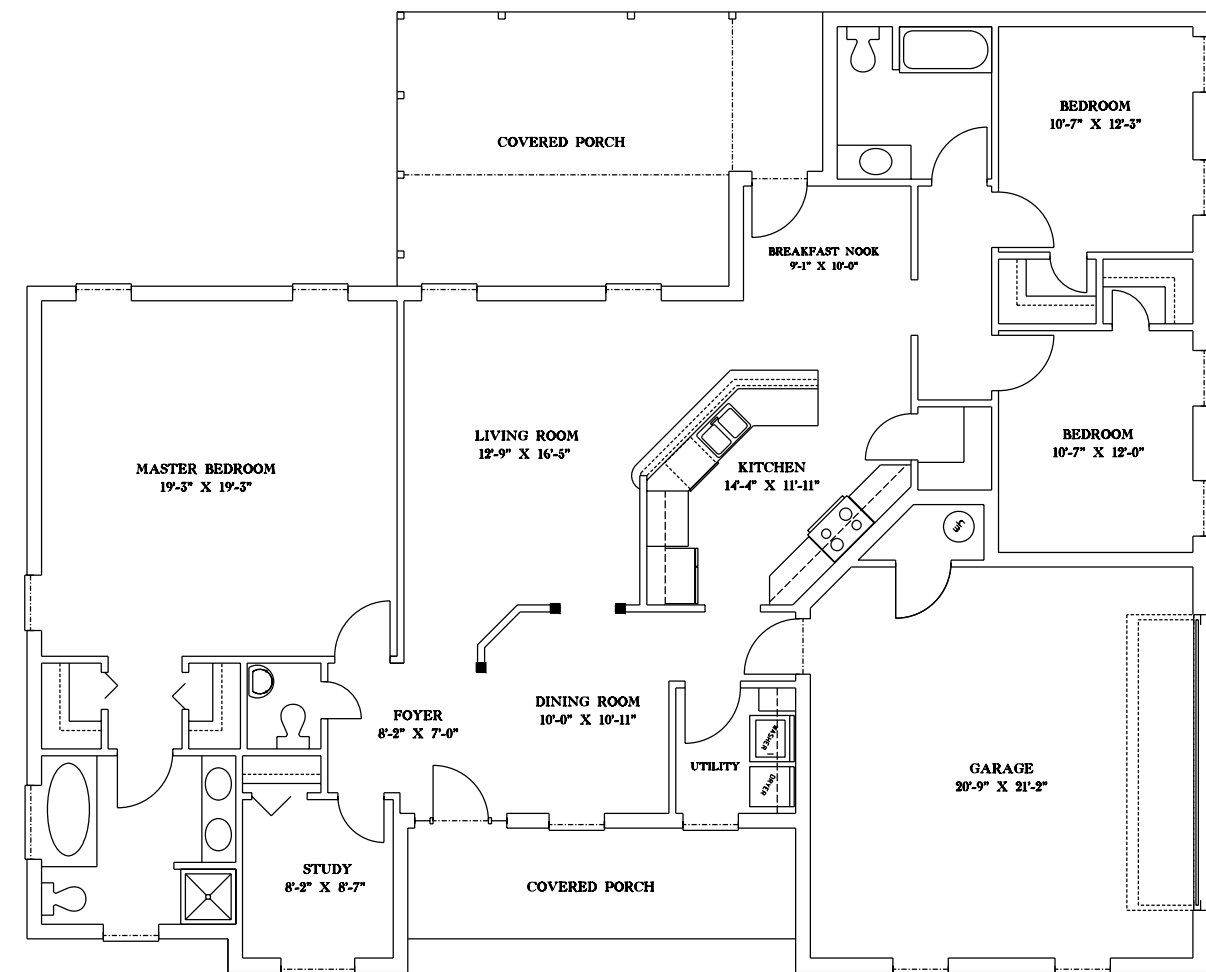

*Dreams Meet Reality*



## ST. LUCIAN

3 BEDROOM, 2 1/2 BATHS, STUDY, AND 2 CAR GARAGE

HEATED AND COOLED SQ. FTGS	2,060 SF
FRONT PORCH SQ. FTGS.	126 SF
BACK PORCH SQ. FTGS.	310 SF
GARAGE SQ FTGS	480 SF
TOTAL SQ FTGS	2,976 SF